

PROC 5501, CT
 Comprised in PROC 474451, Pt
 Regd. Owner Houston Corp R.
 SURVEY BLK. & DISTRICT
 I, II BELMONT
 VIII, XI PAKAKARIKI

LOCAL AUTHORITY
 PORIRUA CITY COUNCIL

Scale 1:4000
 Date FEBRUARY 199

Declaration
 I, A. L. R. BARWICK
 REGISTERED
 HEREBY CERTIFY THAT THIS SCHEME IS
 PREPARED BY ME IN ACCORDANCE WITH
 PROVISIONS OF THE RESOURCE MANUA
 ACT 1991.

APPROVED

OWNE

NOTE: Areas and boundaries sub-
 variation on final survey

SCHEME PLAN 6605



- COMPRISED IN:
- CT 652 725 part
 - PROC 5501 bal.
 - PROC 474451 part
 - PROC 791066 part

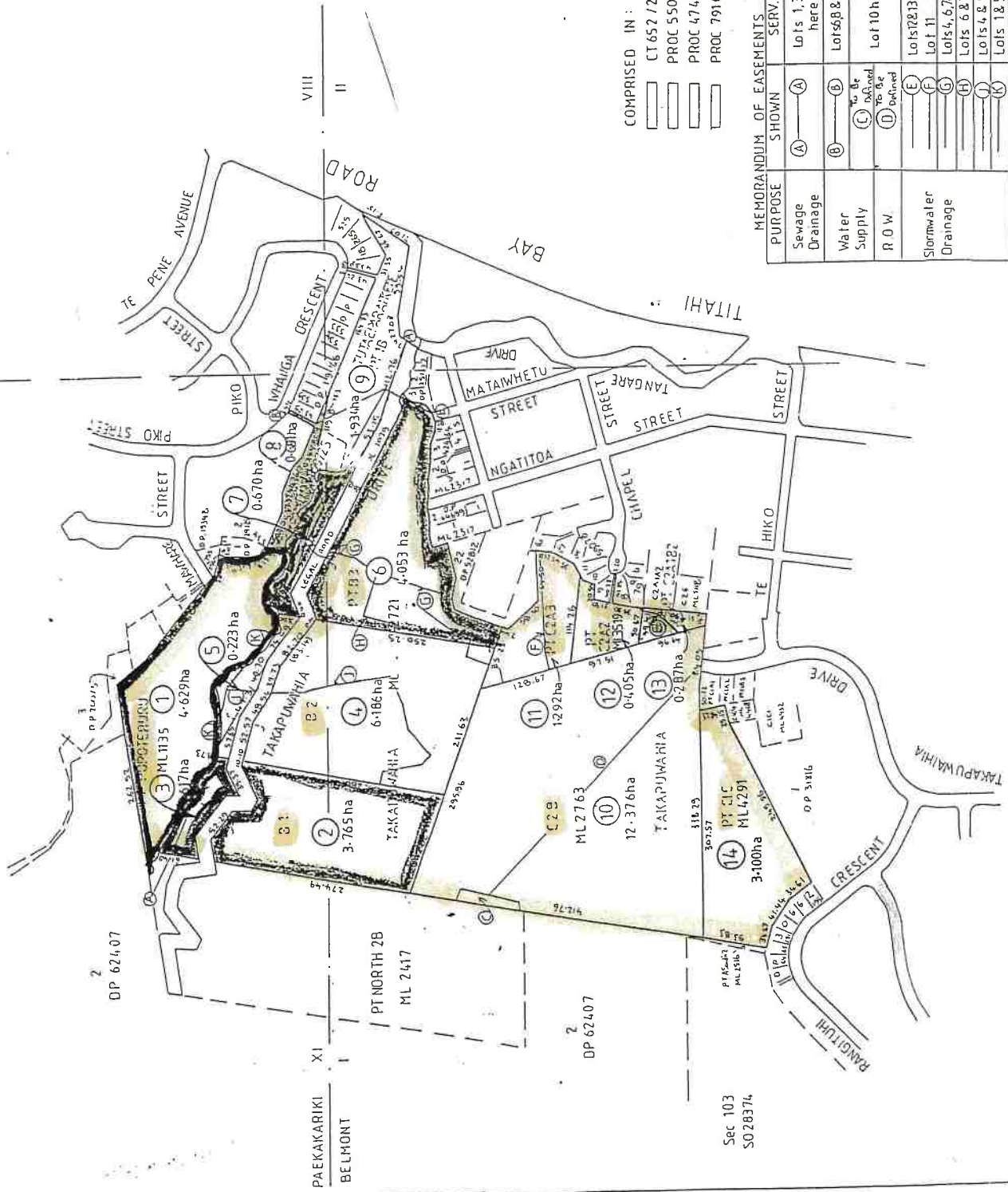

MEMORANDUM OF EASEMENTS

PURPOSE	SHOWN	SERV. TEN.	GRANTEE
Sewage Drainage	(A) - (K)	Lots 1, 3, 5, 7, 8, 9 hereon	PORIRUA CITY COUNCIL
Water Supply	(B)	Lots 8, 8, 9 hereon	PORIRUA CITY COUNCIL
R.O.W.	(C) - (D)	Lot 10 hereon	DOM. TEN.
Stormwater Drainage	(E) - (K)	Lots 2, 13 hereon Lot 11 hereon Lots 4, 6, 7, 8, 11 hereon Lots 6, 8, 7 hereon Lots 4, 8, 5 hereon Lots 1, 8, 5 hereon	Lot 10 hereon Lots 4, 8, 10 hereon Lot 4 hereon Lot 2 hereon Lots 2, 8, 3 hereon

B3 Ref only

Te

SCHEDULE OF OWNERSHIP FOR TAKAPUWAHIA B3

<u>Name</u>	<u>Address</u>	<u>Sex</u>	<u>Share</u>
Adeline Gwen Dawson	44 Rangituhi Crescent Elsdon PORIRUA	f	9.989
Akuhata Edwin		m	1.399
Albert Robson	21 Ashmore Street Halfway Bush DUNEDIN	m	.556
Alice Frances Leonie Dawson	60 Rangituhi Crescent Elsdon PORIRUA	f	9.989
Allan Rotorua Robson	19 Woodhaugh Street North East Valley DUNEDIN	m	.555
Amo Metapere Clark	38 Dunstan Street OTAKI	f	1.800
Anna-Marie Waipunahau Webber	C/- 34 Quinns Road LEVIN	f	.343
Atareta Ropata		f	1.093
Athol Gordon Te Paki otherwise known as Anthony Te Paki		m	26.639
Barry Hapeta		m	.096
Bryan Hapeta		m	.096
Cherrie Ames Edwin	Riwaka RD 3 MOTUEKA	f	1.400
Connie Stebbington		f	.778
Connie Whakaneke	Normanby Road MANAIA	f	.625

Dale Teponga Thompson	46 Doyly Drive Stanmore Bay WHONGAPAROA	m	.155
Daniel Tony Gordon	7 Richardson Place Northcote AUCKLAND	m	.065
David Francis Thompson	21 McLean Road BUCKLANDS BEACH	m	.155
David Stevens		m	5.000
Dawn Parata		f	3.667 2.200
Dawn Pungarehu Edwards	22 Cutler Avenue St Marys 2760 New South Wales AUSTRALIA	f	.065
Deidre Sandra Shelford (Trustee Thomas B Shelford)	123 Rangatohia Drive MANGAKINO	f	.122
Dennis Hayden Nuku	305 The Parade Island Bay WELLINGTON	m	.485
Dinah Wineera - Tr: Maori Trustee		f	19.958
Donald White		m	.064
Douglas Thomas Corlett Reriti as administrator estate of Kuini Kaiwa			79.917
Duncan Tauheke Eriwata	28 New Dapto Road Woollongong 2503 New South Wales AUSTRALIA	m	.065
Epiha Ropata		m	1.094
Erima Gilbert Edwin	C/- P Greggains PO Box 206 WAIKANAE	m	.700

Ernest Hawe Gripp		m	29.167
Eruena Parata	5 Wairoa Street Kaikorai Valley DUNEDIN	m	.146
Eva Watson	3 Lincoln Grove PORIRUA EAST	f	3.667 2.200
Florence Ngaire Meager	15 Adams Street AHBURTON	f	.556
Frederick Haumia Leo Barrett	C/- 46 Dunstan Street OTAKI	m	1.800
George Ramsbottom		m	5.000
Georgina Te Aupiki Thompson		f	.778
Grace J McDonald	15 Primula Street Nudgelee, Brisbane AUSTRALIA	f	1.800
Harata Te Kotua		m	2.915
Harota Eruini		f	3.499
Haweturi Parata	22 Pakington Street WESTPORT	m	.375
Hemaima Nani Hapeta		f	.385
Heranui Ruruku Ware	64 Ngatittoa Street Takapuwahia PORIRUA	f	7.266
Hihi Tutere Ropata		m	1.094
Hine Tau Kupe		f	2.333
Hineatawhai Stephanie Eriwata	C/- 32 Wordsworth Crescent Fairfield HAMILTON	f	.065

Hinewai Roro Solomon	65 Ngatittoa Street Elsdon PORIRUA	f	79.917
Hira Parata II		m	4.500
Hiria Broadhurst	31 Forth Place PAPAKOWHAI	f	.375
Hoani Matenga otherwise known as Hone Matenga or Hoani Uru Matenga		m	183.284
Hohepa Leigh Potini		m	.281
Hohepa Matuaiwi Solomon	3 Ake Ake Grove PORIRUA	m	.562
Huria Rangikauhoe Ngapaki		f	87.500
Jack Martin Webber		m	7.200
James Matanga Robson	Abbots Hill Abbotsford DUNEDIN	m	.555
Janice Te Hauangi Marsh	C/- 12 Meola Road Westmere AUCKLAND	f	.065
Janine Maire Muir	8 Goodall Street MOSGIEL	f	.030
Jason Robert Thompson	Waihi Road WHANGAMATA	m	.156
Jeuvana Anne Noble	579 Page Street Extn STRATFORD	f	.121
John Barr Stevenson and Daniel Francis Barr Stevenson as executors estate of Rongopai Davis	C/- Iazard Weston PO Box 1748 WELLINGTON		23.285

John Barr Stevenson and Mervyn
Edward Kenny as executors of
estate of Te Kahurangi Kenny
otherwise known as Parata

C/- Iazard Weston & Co
PO Box 1748
WELLINGTON

~~2.200~~ 61600

John Harvey

m 87.500

John Robert Robson

50 Shannon Street
ALEXANDRA

m .556

John Roberts otherwise known
as Te Rau Ropata

m 4.375

John Webber Barrett

46 Dunstan Street
OTAKI

m 1.800

Joseph Hapeta Tuaimane Kotua

m 2.915

Josephine Mary Edwin

5 Kanawa Street
WAIKANAE

f .700

Josephine Te Oiroa Kotua

37 Arrow Street
NELSON

f .145

Joy Tane otherwise known
as Mere Taringafoatane

f 4.375

Kahuirangi Maurice

23 Pennant Grove
Onepoto
Titahi Bay
WELLINGTON

f 7.265

Kakakura Jensen Parata

Hongoeka Bay
PLIMMERTON

m 23.429

Kanawa Parata

m 4.500

Kathrine Willie (Mrs)

49 Glover Road
HAWERA

f .122

Kato Doris Ropata

f 1.093

Kauwhata Matenga

m 23.285

Kelvin Barry Nuku		m	.485
Keremia L Potini			.281
Kohi Katene Wallace	27 Babbacombe Avenue OTAKI	f	.555
Kuini Te Paki		f	26.639
Leah Gerretzen	81 Wyndham Street ASHHURST	f	.375
Leo Barrett otherwise known known as Leo Parata or Leo Bartlett		m	5.000
Leo Parata		m	2.200 6.600
Leonard Renata Timothy Kotua		m	2.915
Leslie Robson	131 Rolla Street North East Valley DUNEDIN	m	.556
Lorraine Russell		f	7.200
Lynette Gail Thompson	Flat 3/224 Gowing Drive MEADOWBANK	f	.156
Maaka Stevens		m	5.000
Mahia Inia Thompson otherwise known as Mahia Inia Wright	12 Meola Road Westmere AUCKLAND	f	.842
Makere Inia		f	3.890
Manahi Matenga Baker		m	.556
Manahi Ropata		m	1.094
Marara Parata (deceased)			36.000

Maretta Watson	28 Hocken Street DUNEDIN	f	.555
Margaret Irene McGee	37 Scott Street OTAKI	f	9.990
Margaret Jennifer Gordon	7 Richardson Place Northcote AUCKLAND	f	.065
Marina Lillian Hapeta	8 Osborne Place PAPAKURA	f	.385
Marina Parata for life or until remarriage with remainder to: Mata Kotua	7 Burns Street NEW PLYMOUTH	f	.375
Matau Matenga Baker	Pembroke Street PALMERSTON NORTH	f	11.670
Matengaro Solomon		m	.556
May Josephine Hodgkinson	9 Gordon Road MOSGIEL	m	.563
Miana Jill Webber	66 Albatross Close WHITBY	f	.555
Michael Hugh Muir	16 Church Street MOSGIEL	f	.343
Michael Rikihana Ropata		m	.029
Mick Daymond		m	8.750
Mihipeka Parai Jacobsen	Otzhusumweg 21 2268 Nuekirchen WEST GERMANY	m	0.980
Minnie Rose Semeki		f	7.265
William Walters		f	
Anthony Brett Walters		m	
Michael Gordon Walters		m	
Sarah Jane Walters		f	

Miriama Shelford		f	.121
Miriama Styles	RD 1 MARTINBOROUGH	f	.375
Mita Anaru Te Hoakairangi Kauri	16 Wise Street WAINUIOMATA	m	.292
Moeroa Matai Parai (Mrs Ropata)		f	79.917
Monica Urech	41 Jillett Street TITAHU BAY	f	7.265
Ngahiwi Takamora Dawson	C/- 60 Rangituhi Crescent Elsdon PORIRUA	f	9.990
Ngahuia Ropata		f	1.094
Ngahurumoana Te Whiti		m	36.000
Ngaro, Gilman	7 Minnie Street SHANNON	f	.625
Nina Mary Harkild	114A Rosier Road Glen Eden AUCKLAND	f	26.639
Noel Anthony Shelford	Flat 22, 139A Smith Street Summerhill Sydney AUSTRALIA	m	.121
Noeline Tauruai	PO Box 247 Crawa PAPUA NEW GUINEA	f	.556
Nohinohi Mahima Baker		m	.555
Nohokotahi Luie Hapeta		f	.385
Nunumi Gray	Temuera Street OTAKI	f	.625

Nyahia Rewita		f	2.334
NZ Guardian Trust Co Ltd as trustee of Rangihanu Wharerau Parata, deceased			3.500
Orena Ann Muir	41 Hackett Street Herne Bay AUCKLAND	f	.029
Oriwa Dene Solomon			.562
Painia Te Rauangaanga Hapeta		m	.384
Parataina Peter Hapeta		m	.385
Patricia Louise Thompson for life or until remarriage with remainder to David Samuel Thompson	33B Windsor Place Kallaroo AUSTRALIA	f	.778
Peggy Hapeta		f	.096
Peni Walters for a life estate with remainder equally to Percy Peihatea Akuhata Te Kotua	26 Tyrone Street OTARA		39.958
Piri Kawau Parai (Jnr)	C/- Takapuwahia PORIRUA	m	2.915
Pomare Hemi John Piwari		m	7.265
Public Trustee, Blenheim as administrator of estate of Mere Aare Te Paki (Mrs Grey) otherwise known as Mere Grey	PO Box 441 NELSON		23.285
Pukere Marcus Gripp		m	434.917
Ramiri Ria McDowall	154 Taita Drive LOWER HUTT	f	29.167
Rangi Anewa Parker	36 Cheshire Street PORIRUA EAST	f	5.000
			3.666 2.200

Rarangi Leonie Koa Bowman	C/- 34 Quinns Road LEVIN	f	.343
Rarangi Lyuu Jean Howard	Otaihanga Road PARAPARAUMU	f	2.400
Rarangi Ropata		f	1.094
Ratapu Nelson Leigh Solomon	5 Nohorua Street PORIRUA	m	.562
Raukura Rangahana Smith	337B Nayland Road STOKE	f	.146
Rawatea Rikihana		f	1.400
Raynor Shelford	36 Quigley Road Boulton Point Newcastle New South Wales AUSTRALIA	m	.121
Rena Lesley Thompson	Waihi Road WHANGAMATA	m	.156
Rewa Ellen Webber		f	7.200
Ria Elenor Solomon	3 Ake Ake Grove PORIRUA	f	.563
Richard James Tamati Ellison	Clarendon RD 1 OUTRAM	m	5.000
Rikorero Parata	65 Ruahine Street PARAPARAUMU	m	.375
Rimu Kiriona	Kakahi Road HALCOMBE	m	.625
Roana Julie Webber	Main Road South MANAKAU	f	.343
Roena McCarthy	18 Roseanne Street MANUREWA	f	7.265

Roger Takaratai Eriwata	27 Mt View Street Aspendale Victoria 3195 AUSTRALIA	m	.065
Ronald Parata	471 Kaikorai Valley Road DUNEDIN	m	.146
Russell Talbot Feist and Keith Taylor Matthews as executors of estate of Pahemata Ellison	PO Box 5003 WELLINGTON		5.000
Russell Te Ponanga Eriwata	14 Cicada Place Hornby CHRISTCHURCH	m	.065
Ruve Josephine Hapeta otherwise known as Ruve Josephine McMillan		f	.480
Sally Jane Muir	8 Goodall Street MOSGIEL	f	.029
Sandra Te Pania	11 Horopito Road WAIKANAE	f	1.400
Sharon Parata	f		
Hine Parata	f		
Darryl Parata	m		
Miriama Parata	f		
Linda Parata	f		
David Parata	m		
Tahu Te Whaiti Parata		m	1.167
Taku Jo Parker	Jervois Terrace OHAU	f	.343
Taku Wynne Aromea Williams	29 Rangatira Street OTAKI	f	2.400
Tama Parata		m	2.250

Tamehana Te Karu Thompson		m	.778
Tapuhikura Parata	8 Graham Grove WAIKANAE	f	.375
Tata Winara Parata		m	7.001
Te Apereihana Parata		m	2.200 6.600
Te Huritanga Hapeta		f	.385
Te Ikaherengutu Parai	9 Nule Street Brisbane AUSTRALIA	m	7.265
Te Mahunga Hapeta		m	.385
Te Maunu Paul Stephens	6 Rangatira Street OTAKI	m	5.000
Te Ore Parata otherwise known as Te Oni Parata or Te No Parata	C/- Mrs Kenny Ngatitoo Road PORIRUA	f	13.200 6.600
Te Pehi Parata	53 Beach Road WAITARERE	m	.375
Te Raukarito Matenga Baker	Blackbeech Road AKATARAWA	m	.556
Te Raumoia Matenga Baker	27 Manuka Street OTAKI	m	.555
Te Rauo Kewa Parai	27 Jellico Street TIMARU	m	7.265
Te Rerehua Nicholls	27 Brightwell Street Papakura SOUTH AUCKLAND	f	7.265
Te Taku Parai	64A Ngatitoo Street Takapuwahia PORIRUA	m	7.266

Te Uruhina McNaught		f	.555
Te Waingongi Thompson otherwise known as Barr		f	.778
Temawhero Clinton Hughes Eriwata	32 Wordsworth Crescent Fairfield HAMILTON	m	.064
Tengi Inia		m	3.890
Thelma Joy Waitokorau Solomon	Rosetta Road RARAPARAUMU	f	.563
Thomas Brent Shelford	123 Rangatohia Drive MANGAKINO	m	.121
Tiori Daymond		m	0.970
Tiratu Catherine Elizabeth Gripp		f	29.166
Tiro Parata		f	2.200
Tiro Wakawaka Heperi		f	8.750
Titihuia Ropata		f	1.094
Toa Parata	Queen Street WESTPORT	m	.375
Tohuroa Hira Kauri	56 Seddon Street WAIKANAE	m	.291
Tohuroa Parata	334 Kenmuir Road Kaikorai Valley DUNEDIN	m	.146
Tohuroa Steven Cooke	C/- 36 Chester Street LEVIN	m	.292
Toka Whakaea Kerehoma	72 Grey Street SHANNON	m	4.500

Tuhaha Matenga		m	23.285
Tuhera Kiriona		m	.625
Tungia Dorothea Baker	58 Pukehinau Flats Willis Street WELLINGTON	f	.556
Turanga Matenga Baker		m	.556
Turangapito Parata	24 Murray Avenue HAWERA	m	.375
Tutere Parata	21 Oriwa Street OTAKI	m	.375
Tutipikiao Williams		f	.778
Tutuni Kiriona	Kakahi Road HALCOMBE	m	.625
Umutapu Tabby Hapeta		m	.385
Una Hinemoa Raimapaha Hiroa as executrix of the estate of Maraea Everson	9 Fergusson Street Waiwhetu LOWER HUTT		79.916
Unaiki Stevens otherwise known as Unaiki Snow		f	5.000
Uri Kohika	Pretoria Road SHANNON	f	.625
Paea Kiriona	Kakahi Road HALCOMBE	m	.625
Uruorangi Parata		f	2.250
Verna Odette Shelford		f	.121
Waaka Hapeta		m	.384
Waikuharu Tere Patricia Cooke	36 Chester Street LEVIN	f	.292